



## STANDARD VERSION

Body, 3-layer particle board (E1), melamine coated, highly abrasion-resistant, with 1 mm plastic edge, thickness 19 mm.

Rear panel, 3-layer chipboard (E1), melamine-coated, highly abrasion-resistant, grooved all around, thickness 8 mm.

Back panel, 3-layer chipboard (E1), melamine coated, highly abrasion-resistant, grooved all around, thickness 8 mm.

With possibility to attach the aluminum guide rail for multifunctional panel system.

With center panel.

## OPTIONS

- Decoration group 2
- Shelf (additional)

## STANDARD

FEMB level:2017 (Level 3)

## TECHNICAL SPECIFICATIONS

<b>WIDTH</b>	100 cm
<b>TOTAL HEIGHT</b>	87/128 cm
<b>DEPTH</b>	36/42/48/52/58 cm
<b>NO. OF ADJUSTABLE SHELVES</b>	4
<b>WEIGHT</b>	60 kg

## BENEFITS/SPECIALS



Board material melamine coated with robust plastic edge



Sliding panel with aluminum guide rails and additional storage space behind the panels



Shelf attachment with tidy boxes behind the panels



Pull-out proof shelf supports

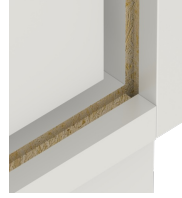

Resistance to warping due to 8 mm thick back wall



Carcass firmly doweled and glued ex works