



STEISSLINGEN COMMUNITY SCHOOL



1



4



5



6



3



2

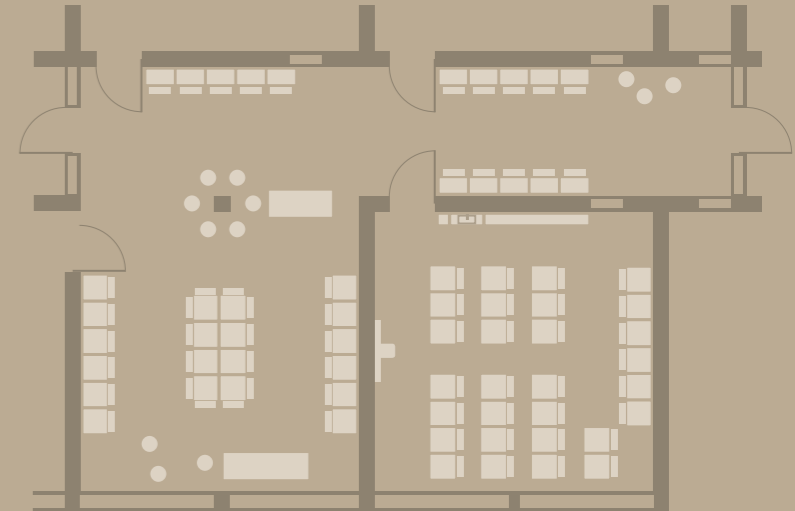

- 1/3 Study carrels in the hallway and tables in the side wing provide opportunities for flexible study, either individually or in small groups. Acoustic panels guarantee peace and quiet and mobile screens ensure concentrated work.
- 2 The classroom can be rearranged for different teaching methods in seconds, thanks to the multifunctional furniture.
- 4 Comfortable, flexible lounge furniture provides an inviting location for a little break or spontaneous encounters.
- 5/6 The individual tables can be linked together easily and flexibly to form rows or groups, ensuring the space always maintains a structured appearance. The Z-frame of the robust plastic Flex chairs makes them easy to lift onto the desk, leaving plenty of space for room cleaning.

BUILDING

Steißlingen community school, 2014

Project

Extension of the community school with an additional building to implement a new pedagogic approach.

Concept

The appearance of the functionally autonomous new block is based on the existing school building and features prefabricated wooden sections with glass cladding as a climate buffer and to protect the facade. The concepts of flexible learning and inclusion require a rethinking of classical room structures: in addition to the canteen, media centre, specialist subject rooms, locker rooms, teachers' work room and the sanitary facilities, classrooms have been created with learning environments that are generously proportioned, immediately accessible and open.

Architects

Dury+D'Aloisio Freie Architekten BDA, Konstanz

FEATURES

Interior Design

Concept

The flexible furnishings allow for all kinds of study styles from classic "chalk and talk" through study groups to individual work in silence. The colour-coding of the various areas provides orientation and reinforces the spatial structuring.

Options

The hallways provide space for individual study or project work in groups, either using mobile screens to create small, sheltered individual study areas or by clustering single-seat desks in the larger group area. The space can be quickly and easily rearranged thanks to the flexible, stacking furniture.

Sustainability

Quality that's made in Germany. Responsible management of resources is essential for products that will shape generations to come. A2S have already netted a host of awards and certificates for their short manufacturing chains, refusal to use solvents and tropical woods and standards that lie well within legal maximums.



DER BILDUNGSEINRICHTER.